

# TAL16

TRIBAL ART LONDON





# TAL16

---

TRIBAL ART LONDON

---

## DATES AND TIMES

31th August	<i>'Opening Preview'</i>	3pm – 9pm
1st September		10.30am – 9pm
2nd September		10.30am – 7pm
3rd September		10.30am – 7pm
4th September		10.30am – 4pm

Mall Galleries  
The Mall, London SW1  
+ 44 7939 166148  
[www.tribalartlondon.com](http://www.tribalartlondon.com)

# TRIBAL ART LONDON EXHIBITORS



Adam Ethnographic Art – UK  
Arjmand Aziz – UK  
Bryan Reeves – UK  
Charles Vernon-Hunt books – UK  
David Malik – UK  
Gallery Lemaire – Netherlands  
Ian Stewart Shaw – Scotland  
Jeremy Sabine – South Africa  
Joss Graham – UK  
Kapil Jariwala Gallery – UK  
Kenn MacKay – UK  
Lisa Tao + Reuben Reubens – UK  
Louis Nierijnck – Netherlands  
Marcuson and Hall – Brussels  
Marcus Raccanello – UK  
Owen Hargreaves + Jasmine Dahl – UK  
Renaud Riley – Belgium  
Rob Temple – Belgium  
Sam Handbury Madin – UK  
Siobhan Andresen – UK  
Tribal Art Magazine – Belgium

1.88

SIOBHAN ANDRESEN / MARCUS RACCANELLO

LISA TAO + REUBEN REUBENS  
GALLERY LEMAIRE  
MARCUSON AND HALL  
RENAUD RILEY  
JOSS GRAHAM

BRYAN REEVES  
LOUIS NIERIJNCK  
ADAM PROUT

TRIBAL ART MA  
CHARLES VERN

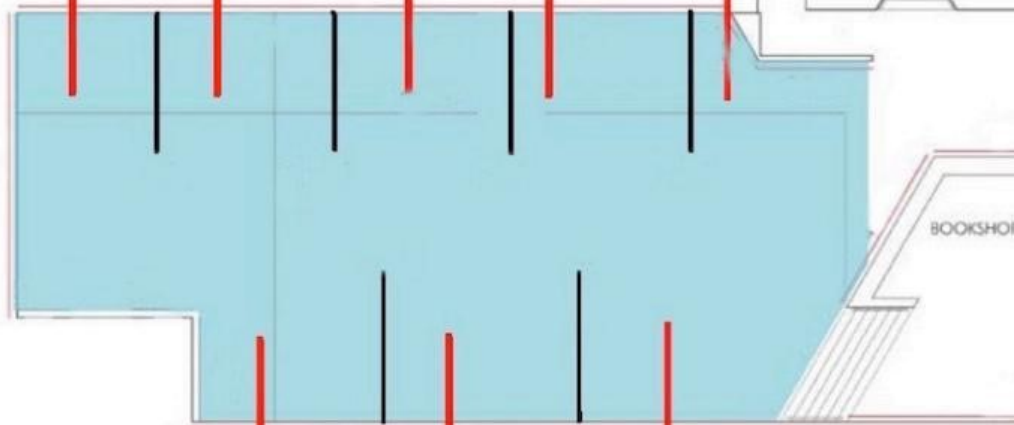

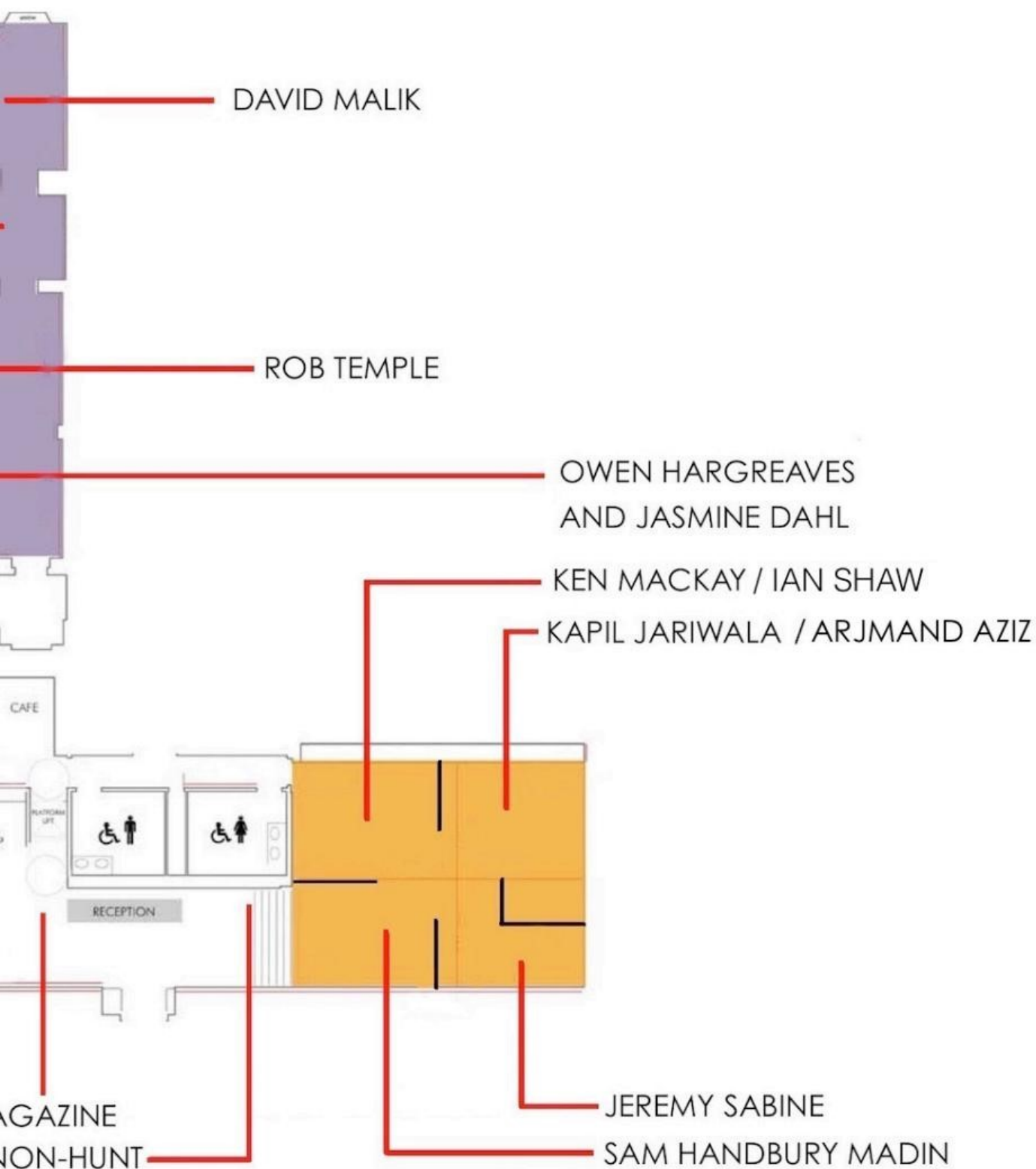



# ADAM ETHNOGRAPHIC ART



Adam Prout  
United Kingdom  
Phone: + 44 (0) 7725689801  
adam@adamprout.com  
adamprout.com

## BURMESE RITUAL WALL MASK ►

Burma  
19th century  
Antler, skin and carved and painted wood  
70cm

The Horniman Museum has two related examples from the original inventory and were collected personally by Mr Horniman in the 1890's

Provenance: U.K. collection







# ARJMAND AZIZ



United Kingdom  
Phone: + 44 (0) 7453322 963  
arjmand.aziz@gmail.com

## "WANDJINA" ►

Lily Karadada (b 1937), Tjarintji/Woonambal  
Kimberley, Australia

2004

Natural earth pigments on pearl shell  
15 cm x 25 cm





# BRYAN REEVES



Tribal Gathering London  
1 Westbourne Grove Mews  
London W11 2RU  
United Kingdom  
Phone: + 44 7939 166148  
[art@tribalgatheringlondon.com](mailto:art@tribalgatheringlondon.com)  
[tribalgatheringlondon.com](http://tribalgatheringlondon.com)

## BAMBARA HYENA MASK ►

Mali  
Wood  
46 cm

**Provenance:** Josef Herman collection, UK







# CHARLES VERNON-HUNT BOOKS



Bookstall at the Harris Arcade  
161 Portobello Road  
London W11  
United Kingdom  
Phone: +44 (20) 8854 1588  
[c.vernonhunt@btinternet.com](mailto:c.vernonhunt@btinternet.com)

Saturday's only 9.00am to 4 pm





ART OF CÔTE D'IVOIRE

VOLUME  
1



ART OF CÔTE D'IVOIRE

VOLUME  
2

mains de maîtres masterhands

FELIX

100 PEOPLES OF ZAIRE AND THEIR SCULPTURE



HANDBOOK

ARTS  
D'AFRIQUE  
NOIRE

Marie-Louise  
Bastin

INTRODUCTION AUX ARTS  
D'AFRIQUE NOIRE



d. waite art of the solomon islands

*Académie Royale de Belgique. — Mémoires (Classe des Beaux-Arts). T. IX, Ser. 2.  
L. de Brabant. — L'Art. Bruxelles.*

XII

F. NEYI

LA GRANDE  
STATUAIRE  
HEMBA  
DU ZAIRE

U.C.L.  
ARTS  
AFRICAINS

ARTS  
D'AFRIQUE  
NOIRE

ARTS du GABON

LOUIS PERROIS

OLÔWÉ of ISÉ: A Yoruba Sculptor to Kings

Walker  
National Museum of African Art

ANTIQUE  
WORKS  
OF  
ART  
FROM  
BENIN

LIEUT.-GEN.  
PITT-RIVERS,  
F.R.S.

ARTS  
D'AFRIQUE  
NOIRE

ARTS ANCIENS  
DU CAMEROUN

Pierre HARTER

Arthur  
P. Bourgeois

ART OF THE YAKA AND SUKU

Alain  
et  
Françoise  
Chaffin  
éditeurs

Christopher  
Roy

ART OF THE UPPER VOLTA RIVERS

Alain  
et  
Françoise  
Chaffin  
éditeurs

THE TORRES STRAIT COLLECTIONS OF ACHADDON MOORE

THE JULIUS L. BRENCHLEY COLLECTION Waite

KING: Artificial Curiosities from the Northwest Coast of America



# DAVID MALIK



United Kingdom  
Phone: + 44 (0) 7864133452  
[david@davidmalikarts.com](mailto:david@davidmalikarts.com)  
[www.davidmalikarts.com](http://www.davidmalikarts.com)

## PUNU MASK ►

Gabon  
Early 20th Century  
Wood  
34 cm

**Provenance:** Christie's Paris, France  
Jan Kusters, Netherlands  
Private collection, London, UK

**Published:** Christie's Paris  
Art Africain, Oceanien et Precolombien  
10 December, 2003, Page 86, Lot 300







# GALERIE LEMAIRE



Finette Lemaire  
Reguliersgracht 80  
1017 LV Amsterdam  
The Netherlands  
Phone: +31 (0)20 6237027, +31 (0)6 24905585  
[info@gallery-lemaire.com](mailto:info@gallery-lemaire.com)  
[gallery-lemaire.com](http://gallery-lemaire.com)

## A COLLECTION OF INDONESIAN FIRE PISTONS ►

Indonesia  
Various material  
6 cm to 13 cm







# IAN SHAW



Alba Tribal Art  
Flat 1/2, 42 Bonnyrigg Drive  
Glasgow G43 1HW  
Scotland  
Phone: + 44 7923924603  
[i.shaw42@yahoo.com](mailto:i.shaw42@yahoo.com)  
[www.albatribalart.com](http://www.albatribalart.com)

## ASHANTE AKUA BA ►

Very early 20th century  
Wood, beads  
33 cm

Provenance: Scottish collection





# JEREMY SABINE



South Africa  
jeremysabine@gmail

## A SOUTH SOTHO SNUFF CONTAINER ► Horn with bone stopper

A companion piece is illustrated in 'Art and Ambiguity', p.136







# JOSS GRAHAM



Phone: +44 (0)20 7730 4370  
10 Eccleston Street  
London SW1W 9LT  
United Kingdom

## EMBROIDERED BANJARA BAG ►

Banjara tribe, Central India  
Early 20th Century  
Textile, lead, cowrie shell tassels







# KAPIL JARIWALA GALLERY



Kapil Jariwala  
2 Talfourd Place  
London, SE15 5NW  
United Kingdom  
Office: +44 (0)20 7701 5861  
Mobile: +44 (0)7957 842 976  
[info@kapiljariwala.com](mailto:info@kapiljariwala.com)  
[www.kapiljariwala.com](http://www.kapiljariwala.com)

## AN ASEN ALTER: A MAN SHOOTING A BABOON ►

Fon people, Quidah, Benin  
19th Century  
Iron  
15.5 cm diameter







# KEN MACKAY



United Kingdom  
[info@tribalartantiques.com](mailto:info@tribalartantiques.com)  
[www.tribalartantiques.com](http://www.tribalartantiques.com)

## A LARGE VERA CRUZ TERRACOTTA HEAD ►

Pre Columbian Mexico  
Classic period Circa 100-600 AD  
Terracotta

Provenance: UK collection







# LISA TAO AND REUBEN REUBENS



Lisa Tao Fine Arts  
United Kingdom  
[lisatao.photo@gmail.com](mailto:lisatao.photo@gmail.com)  
[www.photofromthe1st.com](http://www.photofromthe1st.com)

**LISA TAO ►**

## **THE FESTIVAL OF THE FIRST CANOE**

Owa Raha, Solomon Islands. By Dr Ian Hogbin

Ca 1930

Silver Galetin Print

7 x 5 in







**REUBEN REUBENS ►**  
**FINE ABORIGINAL BARK PAINTING**

Artist: Tygurna. Tribe: Gunwinggu

Western Arnhem Land

2nd half of the 20th Century

81 x 40 cm







# LOUIS NIERIJNCK



Gallery Karavanserai  
The Netherlands  
Phone: + 31 655897485  
[louisnierijnck@gmail.com](mailto:louisnierijnck@gmail.com)  
[www.primitiveart.nl](http://www.primitiveart.nl)  
New website: [www.tribalartnepal.com](http://www.tribalartnepal.com)

## THREE LARGE FIGURES IN ANCESTOR POSTURE ►

Magar people, Nepal  
Wood  
60cm, 64cm, 76cm







# MARCUSSON AND HALL



Rue Pierre Decoster 117  
Brussels 1190  
Belgium  
Phone: +32 (0)2 538 7369  
[www.marcusonandhall.com](http://www.marcusonandhall.com)

## AN ITHUNGA, ZULU MILK POT ►

South Africa  
19th century  
Wood  
42 cm

Exhibited and published: L'ART DE MANGER  
Rites et Traditions en Afrique, Insulinde et Oceanie  
Musée Dapper







# MARCUS RACCANELLO



United Kingdom  
Phone: +44 7795570579  
[info@raccanellotribalart.com](mailto:info@raccanellotribalart.com)  
[www.raccanellotribalart.com](http://www.raccanellotribalart.com)

## TONGAN CLUB ►

Tonga  
Early 19th Century  
Wood  
120 cm

Deep dark red colour, beautiful patina. Chevron and linear design covering the club throughout, 4 human glyphs on one side, 2 on the alternate side. Very good condition

**Provenance:** Abraham Rosman Collection, New York







# OWEN HARGREAVES AND JASMINE DAHL



United Kingdom  
Phone: + 44 2087403547  
[owenhargreaves@easynet.co.uk](mailto:owenhargreaves@easynet.co.uk)  
[www.owenhargreaves.com](http://www.owenhargreaves.com)

## GURUNSI MASK ►

Burkina Faso  
Wood  
40 cm







# RENAUD RILEY



Belgium

Phone: +32 479 50 43 90

[renaud.riley@gmail.com](mailto:renaud.riley@gmail.com)

[www.2r-ritualgallery.com](http://www.2r-ritualgallery.com)

## BWA MASK ►

Burkina Faso

Ca 1930's

Wood

55 cm

Provenance: Michael Oliver, New York







# ROB TEMPLE



Belgium  
Phone: + 32 486447670  
[info@robtemple.com](mailto:info@robtemple.com)  
[www.robtemple.com](http://www.robtemple.com)

## CHOKWE FEMALE FIGURE ►

Angola  
Wood  
38 cm

Elaborate coiffure and raised scarification to abdomen





# SAM HANDBURY MADIN



United Kingdom  
Phone: + 44 (0) 7847358809  
[handburytribalart@gmail.com](mailto:handburytribalart@gmail.com)  
[www.handburytribalart.com](http://www.handburytribalart.com)

## NEW CALEDONIA KANAK PHALLUS WAR CLUB ►

New Caledonia

19th Century

Wood, coconut sennit fibre and trade cloth

75 cm

**Provenance:** Private Belgian collection







# SIOBHAN ANDRESEN



United Kingdom  
Phone: + 44 (0) 7766789586  
shivvy305@hotmail.com

## LOST WAX CAST COPPER ALLOY BRACELETS ►

Kohima District (Nagaland), Manipur, Angami  
Circa early 20th Century  
Copper alloy

Provenance: Private collection, London





# **TRIBAL ART LONDON LECTURE PROGRAMME**

1 – 4 September 2016, Mall Galleries

**ROBERTO GNISCI 1 pm Thursday 1st September**

SMALL BRONZES FROM THE DELTA REGION OF  
WEST AFRICA

**BARBARA HARDING 3.30 pm Thursday 1st September**

THE COLLECTORS

**ARJMAND AZIZ 1 pm Friday 2nd September**

ANCESTRAL POWER: UNDERSTANDING INDIGENOUS  
AUSTRALIAN ART IN THE LAND OF CAPTAIN COOK

**SIOBHAN ANDRESEN 3.30 pm Friday 2nd September**

STATUS AND IDENTITY

**PROFESSOR STEVEN HOOPER 1 pm Saturday 3rd September**

CREATIVITY AND CONTINUITY IN FIJIAN ART  
AND RITUAL

**LOUIS NIERIJNCK 3 pm Saturday 3rd September**

INTRODUCTION TO THE PRIMAL ART OF WEST  
NEPAL

**JANIE LIGHTFOOT ACR 11.30 am Sunday 4th September**

AFRICAN TRIBAL SKIRTS AND APRONS

**RONNIE ARCHER MORGAN 1.30 pm Sunday 4th September**

THE EUROPEANS' ARRIVAL ON THE SHORES OF FAR  
FLUNG TRIBAL COMMUNITIES AND HOW IT IMPACTED  
THEIR ART AND THE THINGS THEY MADE

TRIBAL ART LONDON LECTURE PROGRAMME

# SMALL BRONZES FROM THE DELTA REGION OF WEST AFRICA

BY ROBERTO GNISCI  
1 pm Thursday 1st September



This is a two part presentation that examines in detail the small bronze figures that come from this vast delta region of West Africa. The first of these presentations will focus on the interior regions of Niger including the twin cities of Djenne and Severe, and the highlands near Bandiagara.

'On my first visit to the Djenne territories at the beginning of the distant 80s, there was no evidence of a significant presence of metal archaeological items and the situation did not change in the two successive trips I made. So when five years ago I found, in a collection of African art belonging to a friend in Italy, a group of very fine small bronze pieces from the interior Delta of the Niger I was really shocked. And from that moment on I commenced systematic research into the subject which also led ultimately to my forthcoming book'.

TRIBAL ART LONDON 2016



TRIBAL ART LONDON LECTURE PROGRAMME

# THE COLLECTORS

BY BARBARA HARDING

3.30 pm Thursday 1st September



This lecture gives a unique, first hand, personal perspective on some of the extraordinary people who have collected tribal art over the years. These are people from highly diverse backgrounds but who all shared the same passion.

Included will be Helena Rubinstein, Peggy Guggenheim, Picasso, Jacob Epstein, Emile Bouchard, William Ockelford Oldman, Klaus Perls, and HRH Sheikh Saoud Al-Thani.

TRIBAL ART LONDON 2016

TRIBAL ART LONDON LECTURE PROGRAMME

# ANCESTRAL POWER: UNDERSTANDING INDIGENOUS AUSTRALIAN ART IN THE LAND OF CAPTAIN COOK

BY ARJMAND AZIZ

1 pm Friday 2nd September



Arjmand Aziz is a lecturer and teacher at SOAS, London.

In the last thirty years or so Australia's contemporary, indigenous art has gained considerable recognition and rightfully taken its place as fine art on the international stage. Artists such as Emily Kame Kngwarreye, Clifford Possum Tjapaltjarri and Lena Nyadbi are known and lauded from Pemberton to Paris – and beyond. But how much do international audiences really understand about the sources of these artists' power and authority? Is there a way for a European or, specifically, British audience to perceive Indigenous art outside the oscillating poles of aesthetics and anthropology?

This lecture seeks to answer these questions and shows that the act of making "art" directly vivifies ancestral power into the present moment. And it does so in power, depth and sophisticated ways that we are only just beginning to understand.

TRIBAL ART LONDON 2016

# STATUS AND IDENTITY

BY SIOBHAN ANDRESEN

3.30 pm Friday 2nd September



The power of a ring to protect - the hereditary right to wear certain items of adornment to signify one's status and position. This special adornment, passed down through the generations, is considered so powerful that it is believed to possess ominous magical powers. Some adornment is so precious, that it is not worn on the person, but hung on the outside of the house during feasts and ceremonies.

The wearing of adornment in many cultures is not just about identity and status but about wealth and availability. These objects, once so important to tribal cultures, are now often only seen as 'art' in the Western world.



TRIBAL ART LONDON LECTURE PROGRAMME

# CREATIVITY AND CONTINUITY IN FIJIAN ART AND RITUAL

BY PROFESSOR STEVEN HOOPER

1 pm Saturday 3rd September



Steven Hooper is Director of the Sainsbury Research Unit for the Arts of Africa, Oceania & the Americas at the University of East Anglia.

This talk will highlight the creative adaptability of Fijians since the early 19th Century - how they have responded to external stimuli and materials, and how Fijian culture has remained distinctive in the face of modern challenges.

Skills in working whale ivory into magnificent regalia will be discussed, and the continuing importance of sperm whale teeth in Fijian culture, as well as the long tradition of making wooden kava/yaqona bowls.

Artworks from a range of museum collections will be featured, all of which will be appearing in the major exhibition, *Fiji: Art and Life in the Pacific* at the Sainsbury Centre for Visual Arts, University of East Anglia, Norwich (15 October 2016 - 12 February 2017).

TRIBAL ART LONDON 2016

TRIBAL ART LONDON LECTURE PROGRAMME

# INTRODUCTION TO THE PRIMAL ART OF WEST NEPAL

BY LOUIS NIERIJNCK  
3 pm Saturday 3rd September



The primitive figures from West Nepal are not very well known by many collectors within the world of 'tribal art'.

Nepal was a very closed country until the 1950s and has never been colonized by a Western country. The districts in the middle hills of West Nepal are situated in some of the most inaccessible areas of the world.

Louis Nierijnck, from the Netherlands, has always been fascinated by the pure and primal objects from this region. Hinduism and to a lesser extent Buddhism are the dominant religions in this area. However Louis Nierijnck considers that these 'primitive' objects are much more connected with the old shamanic cultures of Central Asia and Siberia and the ancestor worship cults of South East Asia.

This presentation is not going to be a scientific argument to prove this theory but more a story about his fascination and love for these powerful artefacts.

TRIBAL ART LONDON 2016

TRIBAL ART LONDON LECTURE PROGRAMME

# AFRICAN TRIBAL SKIRTS AND APRONS

BY JANIE LIGHTFOOT ACR

11.30 am Sunday 4th September

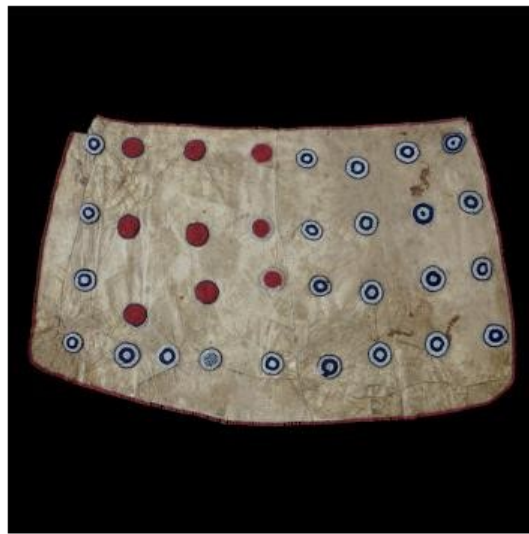

Janie Lightfoot will talk through some of the items that she and David Lightfoot have collected over the past 30 years. She will be looking at the huge variation in aprons and skirts worn throughout time and ceremony in Africa.

The Lightfoot collection is extensive with over 900 objects including beadwork and ceremonial costume.

Janie Lightfoot Textiles LLP Conservation & Restoration studio has been established for over 40 years. Janie, an accredited conservator, has worked extensively in the public and private sector and both nationally and internationally.

She also acts as a consultant for several major institutions; she is an associate lecturer at University of the Arts London and a frequent speaker at conservation and textile conferences.



TRIBAL ART LONDON LECTURE PROGRAMME

# THE EUROPEANS' ARRIVAL ON THE SHORES OF FAR FLUNG TRIBAL COMMUNITIES AND HOW IT IMPACTED THEIR ART AND THE THINGS THEY MADE

BY RONNIE ARCHER MORGAN

1.30 pm Sunday 4th September



Since 2011 Ronnie Archer Morgan has been an expert contributor to the BBC's Antiques Road Show.

He has passionately collected tribal objects for thirty years and speaks purely from the heart.

With his firsthand experience and exposure to the art market, this talk will offer some fascinating insights into today's tribal art scene.

TRIBAL ART LONDON 2016

# **TRIBAL ART MAGAZINE**

Quarterly Journal of the Art,  
Culture and History of traditional peoples  
And old world civilizations.

[www.tribalartmagazine.com](http://www.tribalartmagazine.com)

PRIMEDIA editions  
BP 18  
7181 Arquennes  
T.: +32 67 877 277  
E-mail: [info@tribalartmagazine.com](mailto:info@tribalartmagazine.com)



# TRIBAL ART



*The magazine for collectors*  
Since 1994



[www.tribalartmagazine.com](http://www.tribalartmagazine.com)



# HALI

HALI Publications Ltd  
8 Ability Plaza, Arbutus Street  
London E8 4DT  
United Kingdom

[www.hali.com](http://www.hali.com)  
[www.cover-magazine.com](http://www.cover-magazine.com)



# HALL



ISSUE 187 SPRING 2016  
UK £17 EUR €19 USA \$36  
REST OF THE WORLD \$42  
[WWW.HALL.COM](http://WWW.HALL.COM)

A new perspective on Turkmen carpets



# FOUNDED IN 1925

and published monthly, Apollo is one of the world's oldest and most respected magazines on the visual arts - covering everything from antiquities to contemporary work.

Start your subscription today with 3 months for £10.

Save over 50% off the cover price plus free digital access.

[www.apollo-magazine.com/AFAIRS16](http://www.apollo-magazine.com/AFAIRS16)

# APOLLO

THE INTERNATIONAL ART MAGAZINE



Tribal art  
focus

JULY/AUGUST 2015 90 YEARS OF APOLLO £6.95

# APOLLO

THE INTERNATIONAL ART MAGAZINE

William Kentridge • Miniature mistresses  
Does the art market need more regulation?



**Early Collecting  
in the Pacific**

# ARTKHADE

THE AUCTIONS DATABASE OF ANCIENT ARTS  
FROM AFRICA, ASIA, OCEANIA AND THE AMERICAS

In 2012, ARTKHADE launched a new research service dedicated to the African, Asian, Oceanic and American art market.

Historically very difficult to grasp, this market finds in the ARTKHADE's price database the source of information more complete and comprehensive available.

Including more than 130,000 results and 250,000 images from internationally respected auction houses, with keyword-search access to bona fide auction outcomes from recent to historical, the ARTKHADE database is an essential tool for every collector, art dealer, expert, curator specialised into African, Oceanic, Asian and American art, or for all inquisitive people willing to know more about this specific market.

For more information visit our website:  
[www.artkhade.com](http://www.artkhade.com)



**ARTKHADE**

THE AUCTIONS DATABASE OF ANCIENT ARTS  
FROM AFRICA, ASIA, OCEANIA AND THE AMERICAS

# THE TRIBAL ART **2000** MARKET **2015**



LE MARCHE  
**2000** DE L'ART  
**2015** TRIBAL

**AMA** Art Analytics

— Art Media Agency —







# FIJI

## ART AND LIFE IN THE PACIFIC

THE SAINSBURY CENTRE FOR VISUAL ARTS  
AT THE UNIVERSITY OF EAST ANGLIA, NORWICH

15 OCTOBER 2016 - 12 FEBRUARY 2017

SAINSBURY  
CENTRE  
for Visual Arts

UEA  
University of East Anglia

*Photo credits: Wood headrest with whale ivory inlay (MAA, Cambridge)*

**TAL16**

**TRIBAL ART LONDON**

[www.tribalartlondon.com](http://www.tribalartlondon.com)